

Step by Step Guide to Fitting a Wet Room over a Timber Floor

The construction of a wet room is simple and surprisingly low cost.

Before starting work check there is room for the drain and sufficient fall for the waste. Mark where the Showerlay tray will be fitted. Cut and remove the wooden flooring to expose the joists. Please also refer to the sectional drawing which is available to view www.TileFixDirect.com/pdf/showerlay-installation.pdf



1) The Showerlay tray needs to be fully supported. Loose fix a level timber surface between the exposed joists by fixing battens to the joists. Check the floor is level in all directions.



2) Loose fit the Showerlay tray. The tray may be cut to fit where the tray abuts walls or boxing in. Mark out the drain position on the floor.

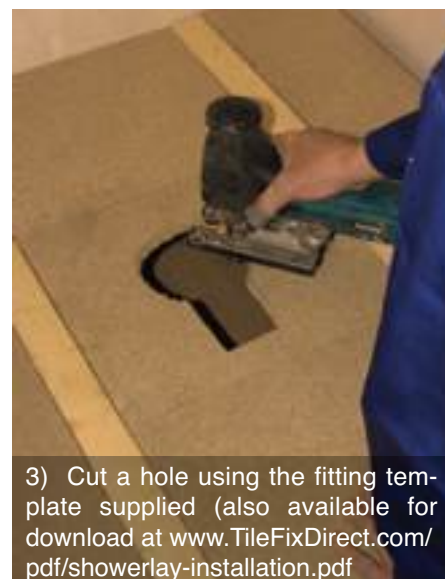

3) Cut a hole using the fitting template supplied (also available for download at www.TileFixDirect.com/pdf/showerlay-installation.pdf)

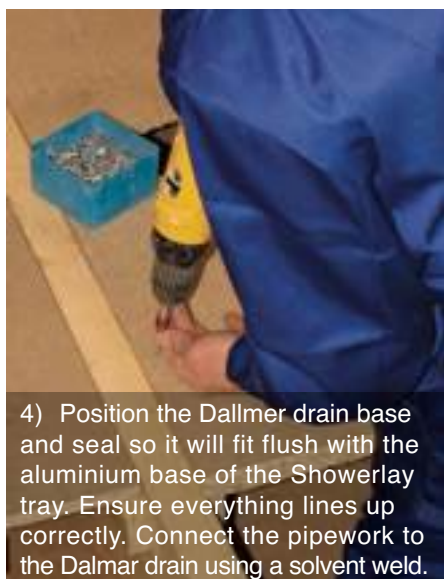

4) Position the Dalmer drain base and seal so it will fit flush with the aluminium base of the Showerlay tray. Ensure everything lines up correctly. Connect the pipework to the Dalmar drain using a solvent weld.



5) Using a 10 x 10mm floor trowel spread a polymer modified cement based adhesive onto the floor and lay the Showerlay tray into the adhesive bed. The adhesive should make 100% contact with tray and floor. Check the tray is level in all directions.

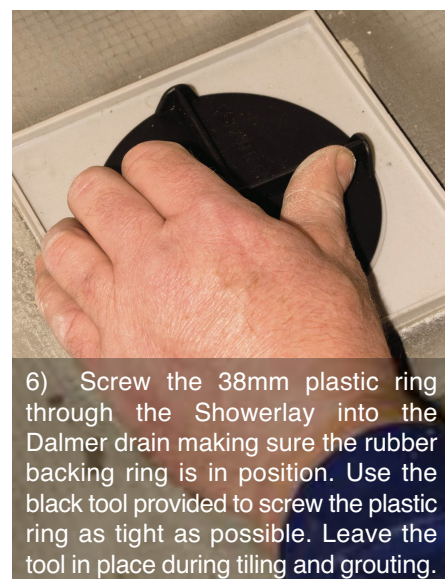

6) Screw the 38mm plastic ring through the Showerlay into the Dalmer drain making sure the rubber backing ring is in position. Use the black tool provided to screw the plastic ring as tight as possible. Leave the tool in place during tiling and grouting.



7) Fit tile backer boards to studwork (or glue and screw to plaster finish) with SUPA PRO stainless steel screws and SUPA PRO tile backer board washers.



8) Run DOW Corning Silicone Sealant along edge of tile backer board and along floor. Slide the next board into the silicone. Ensure the joint is fully sealed.



9) Fix Marmox self adhesive scrim tape along board joint and into internal corners.



10) Run a skim coat of cement based adhesive over the scrim tape. This re-enforces the joint.



11) To the rest of the floor fit GMAT matting*.

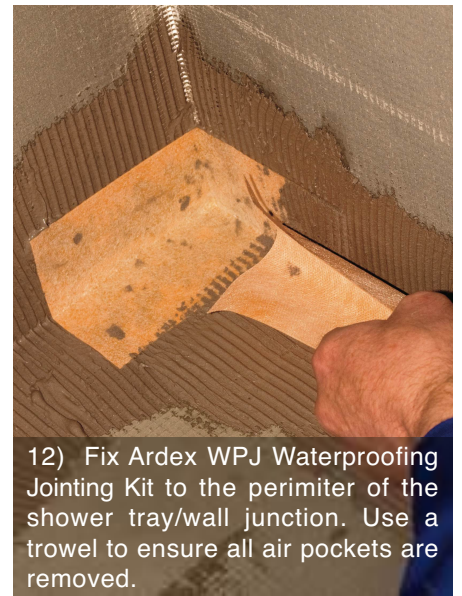

12) Fix Ardex WPJ Waterproofing Jointing Kit to the perimeter of the shower tray/wall junction. Use a trowel to ensure all air pockets are removed.



13) Fit tiles or mosaics to Showerlay tray using a suitable polymer modified cement based adhesive.



14) Remove the black plastic tool, place the hair trap and white funnel in the drain and position the stainless grill.

*If the Showerlay tray is one of the 20mm thick trays use Ardex AF200 acrylic adhesive to fix GMAT. If the tray is one of the 24mm thick trays fit the GMAT with a polymer modified cement based adhesive using a 10 x 10mm trowel.

Close up showing tiling and Showerlay tray cut away to show all the layers.



AQUAPRO
Glass Shower Screens
now available



Aldershot : 01252 333333
Brighton : 01273 597070
Brentford : 0208 847 0441
Hedge End : 01489 797077
Southampton : 0238 063 9977
Winchester : 01962 609960

www.TheTileSource.co.uk